

NOTES:

- 1) PAVEMENT LAYERS AS PER
TYPICAL CROSS SECTION - CUT TO FILL
CONDITION.
2) ROAD MARKING TO BE VERIFIED
ON SITE.

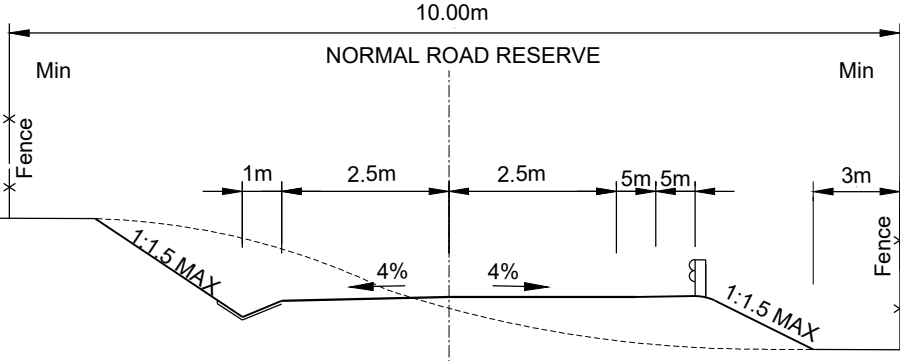

LEGEND

- GRASS LINED TOE DRAIN
--- GRASS LINED 1000 V DRAIN
(SD 0601) & CHUTE (SD 0603/1)
--- PIPE CROSSING WITH DEPRESSED INLET
(SD 0405/A) 600mm PIPE, & HEADWALL
(SD 0406/A).
--- PIPE TO OPEN CHUTE (SD 0704)
--- NATURAL GROUND LINE
--- FINISHED ROAD LEVEL
--- GUARDRAILS (SD 1101/A)

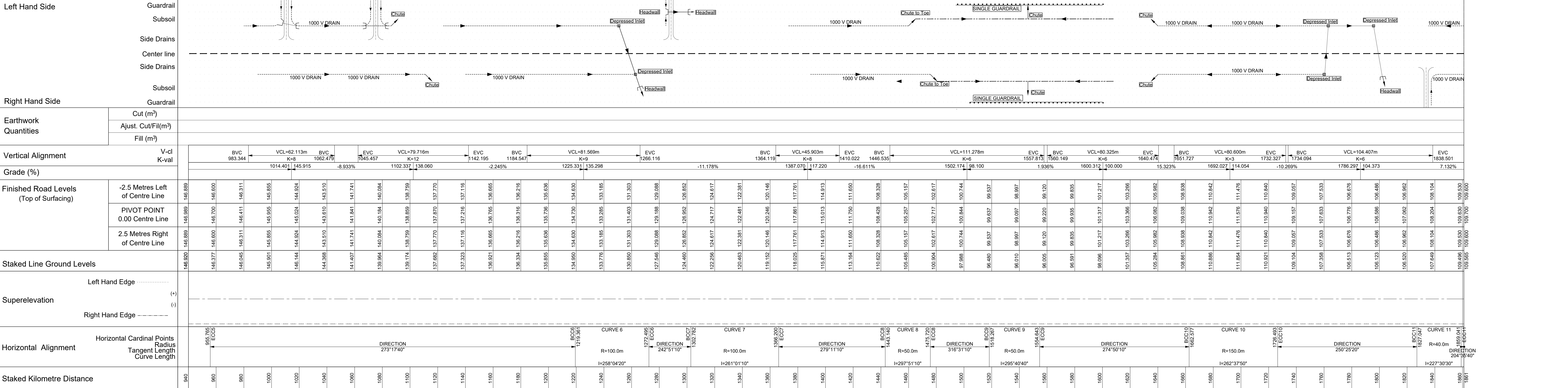

AS BUILT					CONTINUED FROM: -		DESIGNED BY: V. MNYANDU		Designed by:-		Client:- Supplychain Management		Department of Technical Services		THE UPGRADE OF NKANYEZI ROAD - WARD 10		STAKED KM DISTANCE KM 0+000 - KM 0+940		SHEET 2 OF 2										
					CONTINUED ON: -		CHECKED BY: S. NGEMA		NAIDU CONSULTING		Mf Bongani Mfenga P O Box 5 Port Shepstone 4240		Miss Unathi Ngcobo No 10 Conner Street Marburg Port Shepstone 4240		UPGRADING PORTION OF NKANYEZI ROAD : KM 0+000 TO KM 1+800		SCALE HOR 1:1000 VERT 1:1000		PLAN No. 2251/PP										
					CROSS SECTION NO: -		DRAWN BY: V. MNYANDU				Tel: 039 688 2157 Fax: 039 682 0327 Email: khulekani.msomi@rmm.gov.za		Transportation Engineering : CHIEF ENGINEER		WARD 10 LONGITUDINAL SECTION														
					LONG SECTION NO: -		CHECKED BY: S. NGEMA				Naidu Consulting no.:- D722/2250/PP		HEAD : TRANSPORT																
					NAIDU CONSULTING : CONSULTING ENGINEER		SIGN : _____		DATE : _____																				
SYMBOL					DATE					DESCRIPTION					CHECKED					SIGNED					AMENDMENTS				